



# OPERATING INSTRUCTIONS

## HafcoVac Compressed Air Industrial Vacuums



**HafvoVac**  
A product of  
**Hafco Foundry and Machine Company, Inc.**

301 Greenwood Avenue  
Midland Park, NJ 07432

Phone: (201) 447-0433  
Fax: (201) 447-1065

Info@HafcoVac.com  
www.HafcoVac.com

**Thank You** for your purchase of a HafcoVac product. Please follow these assembly and operating instructions for your new industrial vacuum cleaner to ensure optimal operating performance. For your safety, observe all warnings contained herein.

Please keep this instruction manual in a safe place for future reference. Should you misplace this manual, you can download a copy from the HafcoVac website.

If you encounter difficulties operating the vacuum, do not hesitate to contact us by any method listed above.



## Parts List

Part No.	Description	Price	Part No.	Description	Price
<b>Replacement Consumables</b>					
HV-30-11	Gasket for 30 Gallon Cover	\$14	HV-30-10	20" Cover for 30 Gallon Drum	\$125
HV-55-11	Gasket for 55 Gallon Cover	\$14	HV-55-10	24" Cover for 55 Gallon Drum	\$125
HV-30-16	30 Gal Drum Liner, Anti-Static, 10 mil	\$12	HV-30-15	30 Gallon Drum w/ Drainage Bung	\$75
HV-55-16	55 Gal Drum Liner, Anti-Static, 10mil	\$12	HV-55-15	55 Gallon Drum w/ Drainage Bung	\$75
HV-7028	Gasket for Venturi Box	\$3	HV-30-20	Caster Base for 30 Gallon Drum	\$88
HV-7054	Elbow Gasket	\$3	HV-55-20	Caster Base for 55 Gallon Drum	\$98
HV-7037	Standard Filter	\$35	HV-7013	Caster	\$8
HV-7037-6	Standard Filter 6-pack	\$195	HV-7015	20' of 3/4" I.D. Air Supply Hose with Fittings	\$60
HV-7038	Cloth Internal Filter Bag	\$20	HV-7024	Air Jet 1/4" Bore for 100 CFM models	\$10
HV-7038-6	Cloth Internal Filter Bag 6-pack	\$110	HV-7059	Air Jet 3/16" Bore for 60 CFM models	\$10
HV-7033	Silencer for Exhaust Housing	\$14	HV-7027	Venturi Box, Aluminum	\$125
HV-7063	HEPA Filter	\$195	HV-7031	Liquid Shut-Off	\$45
<b>2" Hose and Tools</b>					
HV-7017	2" Hose Coupler	\$10	HV-7032	Exhaust Housing With Cap	\$55
HV-7018	2" Crevice Tool, Steel	\$20	HV-7039	Springs(set)	\$3
HV-7019	2" Hose Elbow Adapter	\$22	HV-7043	1/2" (M/F) Ball Valve	\$15
HV-7020	2" x 25' Grey Polyethylene Hose with Cuffs	\$68	HV-7044	1/2" Universal Coupler	\$8
HV-7060	2" x 20' Heavy Duty Hose with Cuffs	\$175	HV-7052	Venturi 5/8" Throat	\$20
HV-7064	2" x 25' Static Conductive Hose	\$150	HV-7057	Venturi 3/4" Throat	\$20
HV-7021	12" Wet/Dry Floor Tool	\$50	HV-7053	Inlet Elbow	\$16
HV-7022	4' (2 pc) Steel Wand, 2"	\$65			
HV-7023	12" Wet/Dry Floor Tool with 4' (2 pc) Wand, 2"	\$110			
HV-7026	2" Gulper Wand	\$22			
HV-7066	2" Static Dissipation Kit	\$50			
<b>1 1/2" Hose and Tools</b>					
HV-7040	1 1/2" Hose Coupler	\$10			
HV-7042	1 1/2" Crevice Tool, Aluminum	\$20			
HV-7045	1 1/2" Hose Elbow Adapter	\$22			
HV-7025	1 1/2" x 25' Grey Polyethylene Hose with Cuffs	\$48			
HV-7061	1 1/2" x 20' Heavy Duty Hose with Cuffs	\$135			
HV-7065	1 1/2" x 25' Static Conductive Hose	\$105			
HV-7062	12" Wet/Dry Floor Tool	\$40			
HV-7049	4' (2 pc) Steel Wand, 1 1/2"	\$45			
HV-7050	12" Wet/Dry Floor Tool with 4' (2 pc) Wand, 1 1/2"	\$85			
HV-7051	1 1/2" Gulper Wand	\$22			
HV-7047	12" Bristle Floor Tool, 1 1/2", Aluminum	\$45			
HV-7048	12" Squeegee Floor Tool, 1 1/2", Aluminum	\$45			
HV-7046	5" Round Brush Tool, 1 1/2"	\$34			
HV-7041	6" Utility Tool with Detachable Brush, 1 1/2"	\$48			
HV-7067	1 1/2" Static Dissipation Kit	\$50			



All prices are current as of June 2007. Prices are subject to change without notice. Please check website for most current pricing, and to order parts and accessories.

# Vacuum Head Parts Diagram

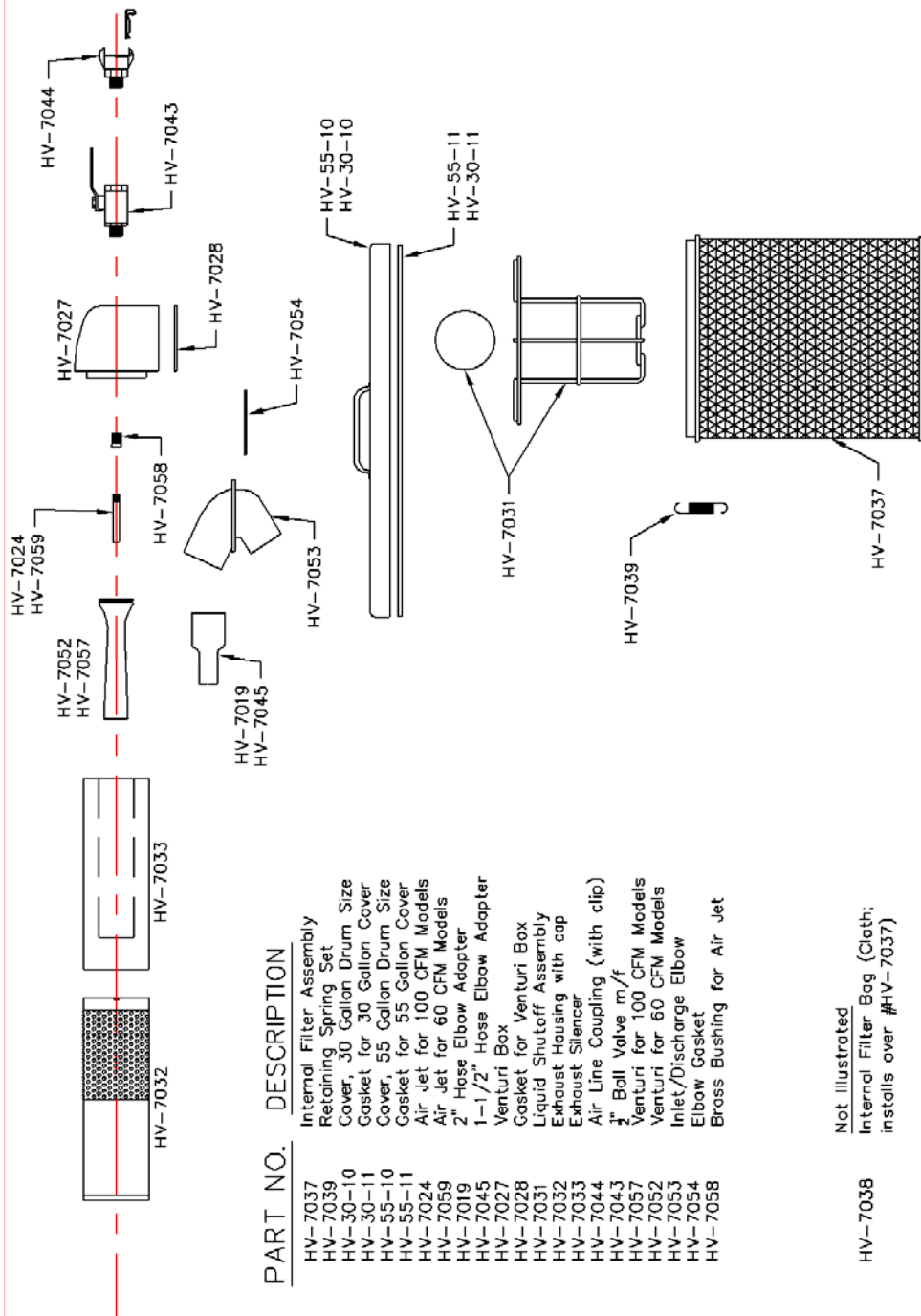

**PART NO. DESCRIPTION**

- HV-7037 Internal Filter Assembly
- HV-7039 Retaining Spring Set
- HV-30-10 Cover, 30 Gallon Drum Size
- HV-30-11 Gasket for 30 Gallon Cover
- HV-55-10 Cover, 55 Gallon Drum Size
- HV-55-11 Gasket for 55 Gallon Cover
- HV-7024 Air Jet for 100 CFM Models
- HV-7025 Air Jet for 60 CFM Models
- HV-7019 2" Hose Elbow Adapter
- HV-7045 1-1/2" Hose Elbow Adapter
- HV-7027 Venturi Box
- HV-7028 Gasket for Venturi Box
- HV-7031 Liquid Shutoff Assembly
- HV-7032 Exhaust Housing with cap
- HV-7033 Exhaust Silencer
- HV-7044 Air Line Coupling (with clip)
- HV-7043 3/4" Ball Valve m/f
- HV-7057 Venturi for 100 CFM Models
- HV-7052 Venturi for 60 CFM Models
- HV-7053 Inlet/Discharge Elbow
- HV-7054 Elbow Gasket
- HV-7058 Brass Bushing for Air Jet

Not Illustrated  
 HV-7038 Internal Filter Bag (Cloth; installs over #HV-7037)

# Unpacking



**After removing your unit from the shipping box, check for parts that may have been placed inside the vertical pieces of cardboard in the box corners.**

HafcoVac vacuum heads are shipped fully assembled and ready to use. If you ordered a head with a tool kit, or a la cart tools or hoses, they are generally included in the same box, so please check carefully to avoid discarding them with the packaging. If you ordered a liquid shut off valve (HV-7031), it is installed inside the standard filter for shipping purposes.

Complete units ship fully assembled, with the exception of the caster base (dolly). See the subsequent section for assembly instructions.

If your unit is a demonstration unit, or you think you may need to return the vacuum, you should save the original packaging to ensure that the unit is not damaged upon return shipping. Units returned improperly packaged, damaged or missing parts will be the responsibility of the customer.

# Caster Base Assembly

The caster base (HV-30-20 or HV-55-20), or dolly, is the only component that needs assembly. You will need the following parts for assembly, all of which are included:

- (20) 7/16 bolts
- (20) 7/16 nuts
- (2) Steel cross members (one should have an offset)
- (4) Casters

You will also need 2 - 7/16 ratchet or wrenches, not provided.

Place the cross members perpendicular to one another. Place the piece with the offset in the center of the bar on the bottom. Align up the holes and bolt the pieces together. Attach the 4 swivel casters with 4 bolts each to each corner of the cross members.



## Air Requirements

Your HafcoVac vacuum is designed to work optimally at 60 or 100 cubic feet per minute (CFM) at 100 pounds per square inch (PSI). Air supplies that don't meet these minimums will drastically reduce the performance of your vacuum. Follow the guidelines below to ensure that your unit will perform up to specifications.

- 100 CFM at 100 PSI for models designated HV-\*\*-\*\*10\*
- 60 CFM at 100 PSI for models designated HV-\*\*-\*\*60\*
- All hoses and fittings from the compressor to the vacuum must be a minimum of 1/2" inner diameter. If you wish to change fittings to a different style, ensure they don't restrict this dimension.
- 3/4" hose is recommended. Be sure to verify the inner diameter of the hose, not just the outer.

If you are unsure of your air supply, the table below will serve as a general guide for sizing your compressor. Keep in mind that horse power is not the only requirement, and that factors such as storage tank size and duration of use play a large role also.

CFM	HafcoVac Model	Compressor HP
100	HV-**-**10*	25
60	HV-**-**60*	15

## Operating Instructions



**Never disconnect a pressurized air line. Turn air supply off at nearest valve and open the valve to release remaining air before disconnecting.**



**Do not use a HafcoVac to pick up explosive or flammable materials without purchasing a static conductive hose (HV-7064 or HV 7065) and a static dissipation kit (HV-7066 or HV-7067).**

To operate the vacuum, you must connect the airline between the vacuum and your air supply. The Chicago, or Universal fittings connect and disconnect by pushing in and twisting. Be sure to connect them securely by twisting them until they stop and the safety clip pins are aligned. Use the supplied safety clips at all times.



**Always used the supplied safety clips on all air fittings. HafcoVac will supply replacements free of charge to ensure your safety.**

If your application does not require full suction, simply open the ball valve to vacuum head only partially. Lower airflow results in a correspondingly lower suction with less of a demand on your compressed air.

When picking up liquids, uninstall the filter by removing the retaining springs and separate the head and the filter. Use of a liquid shut-off valve (HV-7031) is highly recommended when picking up liquids to prevent overflow and possible damage to the exhaust silencer. The liquid shut-off valve installs using the same retaining springs as those used for the filter.

When using the vacuum to pick up flammable liquids or material, be sure to use a static conductive hose, and ground the lid, hose, drum and dolly to ensure proper static dissipation.

## Troubleshooting

If your vacuum doesn't perform as expected, verify the following items:

- Clean or replace filter. Compressed air can be used to clean filter media.
- If installed, wash outer filter bag.
- Be sure air supply is adequate. Fittings with an inner diameter of less than 1/2" will restrict air supply.
- Vacuum hose and elbow on vacuum head should be free of obstruction.
- Vacuum head must make a good seal with the drum. Lip of drum should have no dents, and the drum should have no punctures. Check and replace seal on bottom of vacuum head if needed (HV-30-11 or HV-55-11).
- Check and replace gaskets under the venturi (HV-7028) and the elbow (HV-7054) on the top of the vacuum head.

## Lifetime Warranty

HafcoVac takes pride in our product and values our customers. As such, HafcoVac offers a limited lifetime warranty to all original end-users of our products. Generally, this warranty applies to defects in material and workmanship when the product fails under normal conditions. Damage caused by conditions including, but not limited to the following are expressly excluded: modification to any component or assembly, solvents, corrosives, or harsh environmental conditions. Also excluded are all components considered consumables, such as gaskets, filters or exhaust silencers.